

Event Space & Capacities

FIRST FLOOR

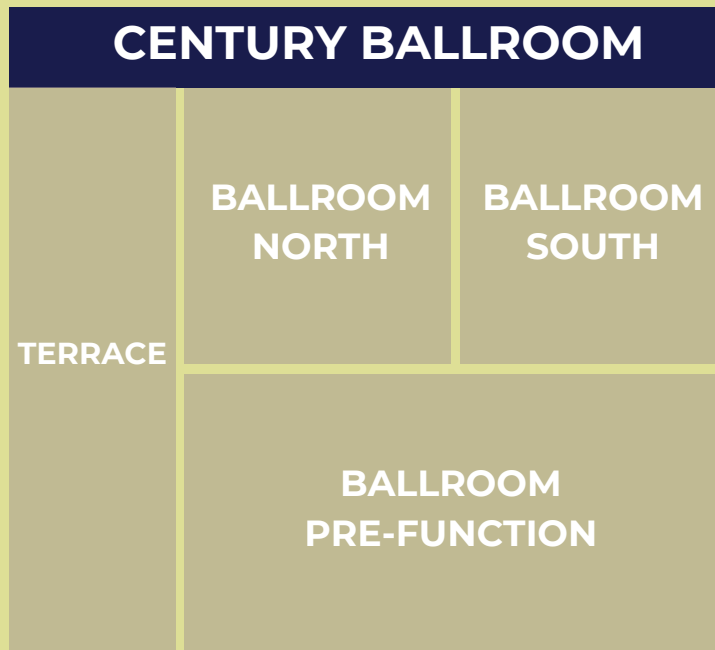

SECOND FLOOR



BRISTOL EVENT CENTER SPACE CAPACITIES

Meeting Room	GSF	Ceiling Height	Booths*	Banquet	Classroom	Theater	Crescents - 6	Crescents - 8	Reception
Century Ballroom	9,407	30'	40	500	450	800	300	400	1,000
<i>Century North</i>	4,930	30'	20	200	264	450	216	288	300
<i>Century South</i>	4,293	30'	15	180	264	400	180	240	300
Niznick Lecture Room	2,406	18'	N/A	100	60	150	60	80	N/A
Ballroom Pre-Function	7,500	30'	26	150	60	200	90	120	400
Outdoor Terrace	8,000	N/A	N/A	400	N/A	500	240	320	500

*Booths were measured based on 10'x10'